



Campus Conversation 2.0  
**Student Success  
& Global Initiatives**

Dr. Taylor Eighmy & Dr. Kimberly Espy  
February 21, 2019

# Campus Conversations 2.0

**External Relations**  
August 3, 2018

**Faculty Senate**  
August 15, 2018

**Communications Collective**  
October 11, 2018

**Student Government  
Association**  
October 18, 2018

**Athletics**  
December 11, 2018

**Alumni Board**  
January 23, 2019

**Audit, Compliance and  
President's Office**  
January 31, 2019

**VPREDKE**  
February 20, 2019

**Student Success and Global  
Initiatives**  
February 21, 2019

**Strategic Enrollment and  
Institutional Intelligence**  
March 13, 2019

**College of Language and  
Fine Arts**  
TBD

**UC, Honors and Graduate  
School**  
TBD

**Library, Art Collections and  
Institute of Texan Cultures**  
TBD

**Academic Affairs Division**  
TBD

**College of Engineering**  
TBD

**College of Sciences**  
TBD

**College of Business**  
TBD

**COACP & COPP**  
TBD

**College of Education &  
Human Development**  
TBD

**Department Chairs Council**  
TBD

**Student Affairs Division**  
TBD

**Business Affairs Division**  
TBD

**Staff Council**  
TBD

The left side of the slide features a vertical column of decorative wavy lines. Most are blue, but there are two orange ones interspersed. The lines vary in length and are arranged in a somewhat irregular pattern.

# Updates & Recent Accomplishments

# Biennial Budget

---



# New Campus Senior Leadership

---



**Myron Anderson**

Vice President for  
Inclusive Excellence



**Veronica Mendez**

Vice President for  
Business Affairs



**Kendra Ketchum**

Vice President for  
Information Management &  
Technology



**LT Robinson**

Interim Dean of Students





Graham Weston  
**\$15 Million Gift**

For UTSA's proposed  
School of Data Science



# Expanding the Downtown Campus **Land Transfers Valued at \$13 Million**

Parcels from the City of San Antonio and Bexar County for the National Security Collaboration Center, the School of Data Science and a new home for the College of Business



Architect selected  
**School of Data  
Science &  
National Security  
Collaboration Center**

---



# **JACOBS<sup>®</sup>**

# **OVERLAND**



# Urban Education Institute Foundational Gift

Finding solutions for  
San Antonio's urban  
education challenges

**\$2.0 million**

**RAISE**<sup>®</sup>  
YOUR HAND TEXAS  
FOUNDATION

Reaccreditation efforts  
**are on track**  
for 2020 review

---

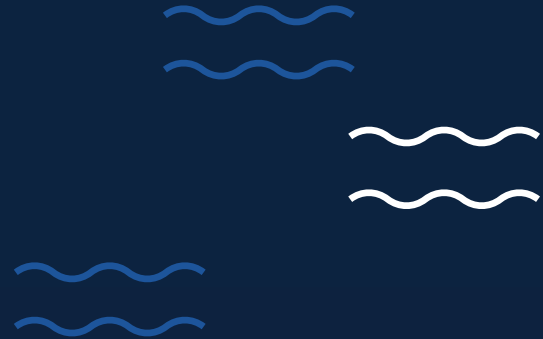

# **RACING TO REACCREDITATION 2020**

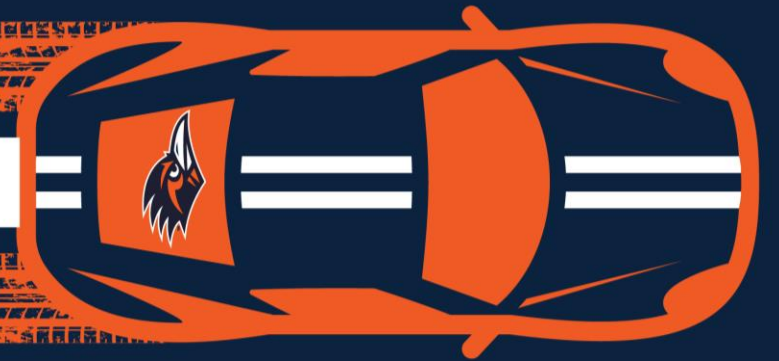



# Civic Discourse and Engagement

[utsa.edu/civicdiscourse](https://utsa.edu/civicdiscourse)

## Resources

- Trainings
- Workshops
- Guests Speakers
- Curriculum Integrations
- Programming

## Academic Focus

- Library Guides
- Academic Inquiry & Scholarship
- Honors College / Top Scholars
- University-Wide Certificate in Community Engaged Leadership
- COPP Civic Engagement Minor



# Diversity and Inclusion at UTSA

[utsa.edu/diversity](https://utsa.edu/diversity)

- Data and Reports
- Inclusion Partners
- Trainings
- Awareness and Programming
- Reporting Discrimination



# Safe Campus

Information and Resources on  
Preventing Sexual Violence

[utsa.edu/safecampus](https://utsa.edu/safecampus)

---

## Awareness Campaigns

- Beaks Up. Speak Up.
- Bringing in the Bystander ©
- Take Back the Night
- Call to Action Day
- One Love Foundation – UTSA Athletics

## Initiatives

- Culture of Respect Collective
- Texas Association Against Sexual Assault
- Violence Prevention Advisory Committee



**UTSA<sup>®</sup>**



*1969-2019*

# New Appointments in Academic Affairs

---



**David Silva**

Dean of the College of Sciences



**Ambika Mathur**

Vice Provost for Graduate Studies and Dean of the Graduate School



**Lisa Montoya**

Vice Provost for Global Initiatives



**Gordon Taylor**

Vice Provost for Academic Finance and Administration



# Search for Vice Provost for Academic Innovation

Reorganization of the previous Chief Online Learning Office position

Lead the university into its next phase of innovative pedagogy and academic programs

Build learning infrastructure and pedagogical pathways by bringing together Online Learning and Programming, Teaching and Learning Services, Video Production, and Learning Technologies

Develop and expand access to UTSA's cutting edge, compelling academic programs







## Academic Affairs “At the Center”

---

Re-integrated under Provost  
to better serve students and faculty

- Faculty Affairs & Support
- Student Success
- Strategic Enrollment





## Commitment to Diversity

---

Increase the number of faculty from underrepresented groups by 50% over the next decade

- Annual targets for each college
- Action plans by each dean

Leadership in diversity and inclusion now part of deans' annual and 360 reviews

- Aspire Alliance
- 

# Focus on Faculty

---

New Innovation and Impact Award for faculty-led teams

Updated workload policy to align with UT System policy

Automated faculty review in Digital Measures

New travel program to include non-tenure-track faculty

Updated promotion and tenure criteria

- more comprehensive
- better measure impact

Transparent process for soliciting external reviews



**UTSA<sup>®</sup>**



*1969-2019*

The logo for UTSA (University of Texas at San Antonio) is located in the upper left corner. It consists of the letters "UTSA" in a white, bold, sans-serif font. Above the text are three wavy lines: the top one is orange, and the two below it are blue. The entire logo is set against a dark blue background with a decorative, wavy white border on the left side.

UTSA®

---

# Strategic Implementation Plan

# 10 Aspirant Peer Models of Excellence



UC SANTA CRUZ



Carnegie RI  
Institutions

UMBC



# UTSA in 10 Years

**4+**

thriving campuses, with  
more under consideration

**>>45,000**

students

**>2,000**

faculty

**>>85%**

first-year retention rate

**6-8**

areas of scholarly  
distinction

**R1**

Carnegie classification,  
with access to the National  
Research University Fund

**>\$300M**

in annual research  
expenditures

**>>\$400M**

endowment

**>>35%**

four-year graduation rate

**>>\$1B**

annual budget

**>300**

endowed  
chairs/professorships

**>15**

faculty in the  
national academies

**>25**

faculty receiving  
prestigious awards  
annually

**>>60%**

six-year graduation rate

**>3 million ft<sup>2</sup>**

new construction  
across campuses

## UTSA's 10-Year Destinations

---

A model for  
student success

A great public research  
university

An exemplar for **strategic  
growth and innovative  
excellence**





# A model for student success

UTSA is a next generation Hispanic-thriving, multicultural institution where students from all backgrounds can excel. As a prosperity engine graduating world-engaged civic leaders of tomorrow, UTSA provides students with exceptional opportunities for experiential learning and classroom to career education.

# A MODEL FOR STUDENT SUCCESS

## First-Year Retention

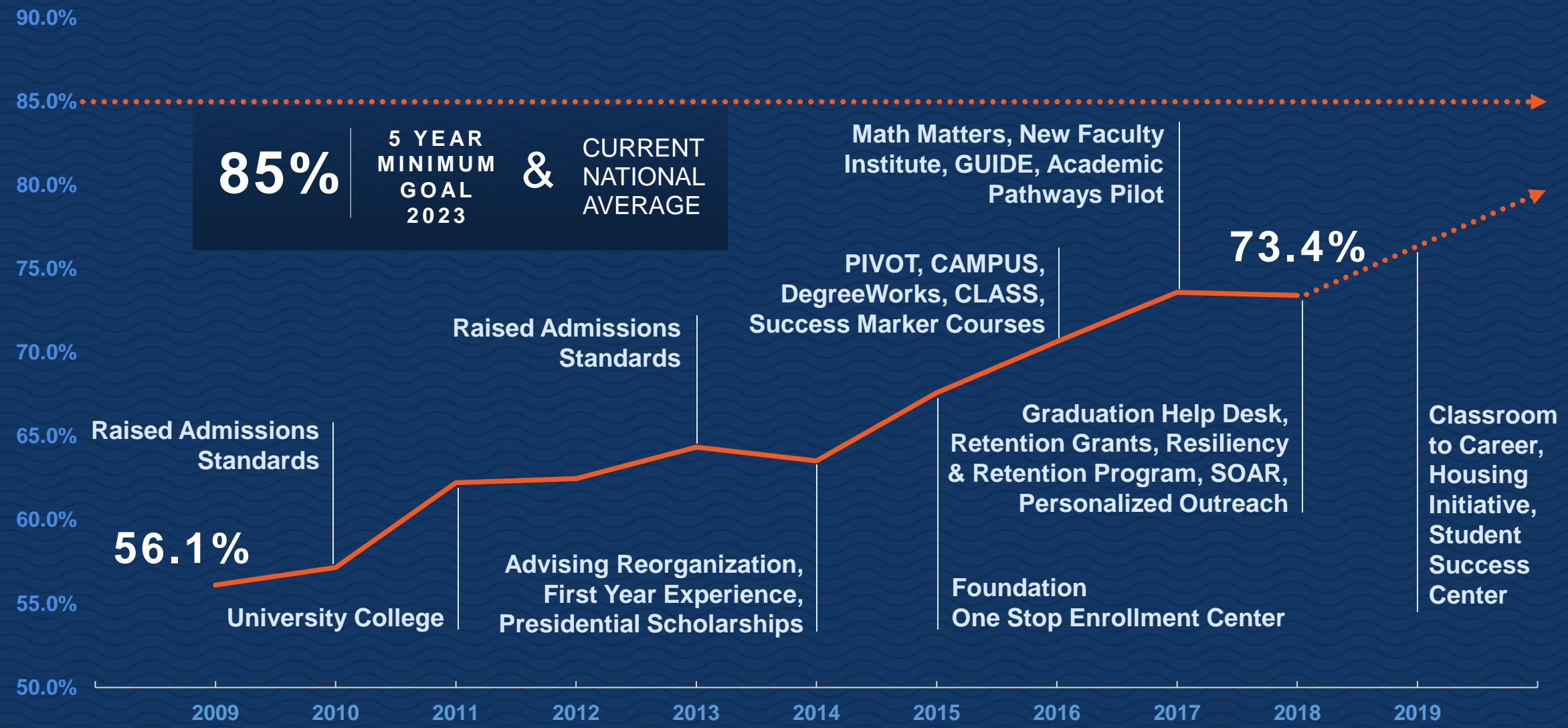

Data as reported to the Integrated Postsecondary Education Data System (IPEDS)

# Second-Year Persistence

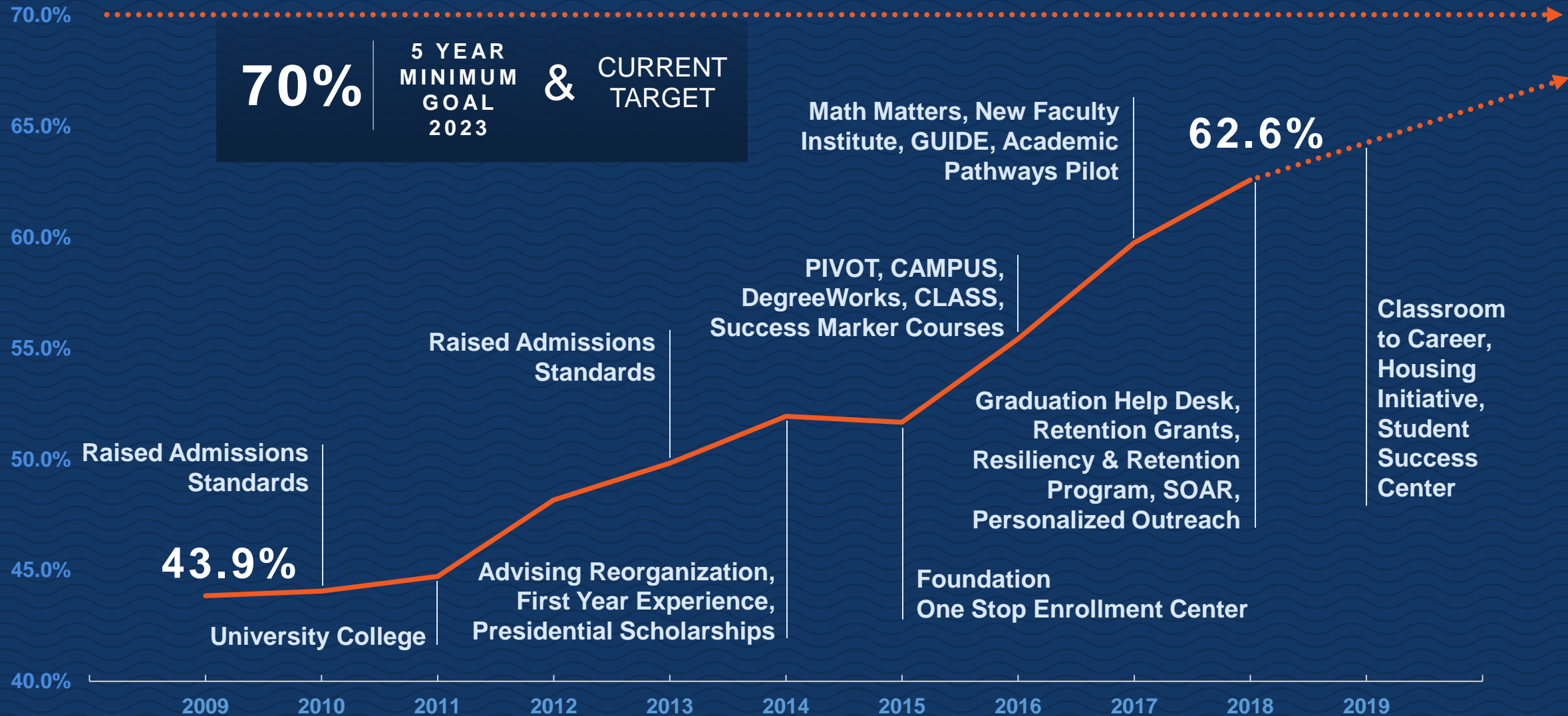

**70%**

5 YEAR  
MINIMUM  
GOAL  
2023 & CURRENT  
TARGET

# A MODEL FOR STUDENT SUCCESS

## Third-Year Persistence

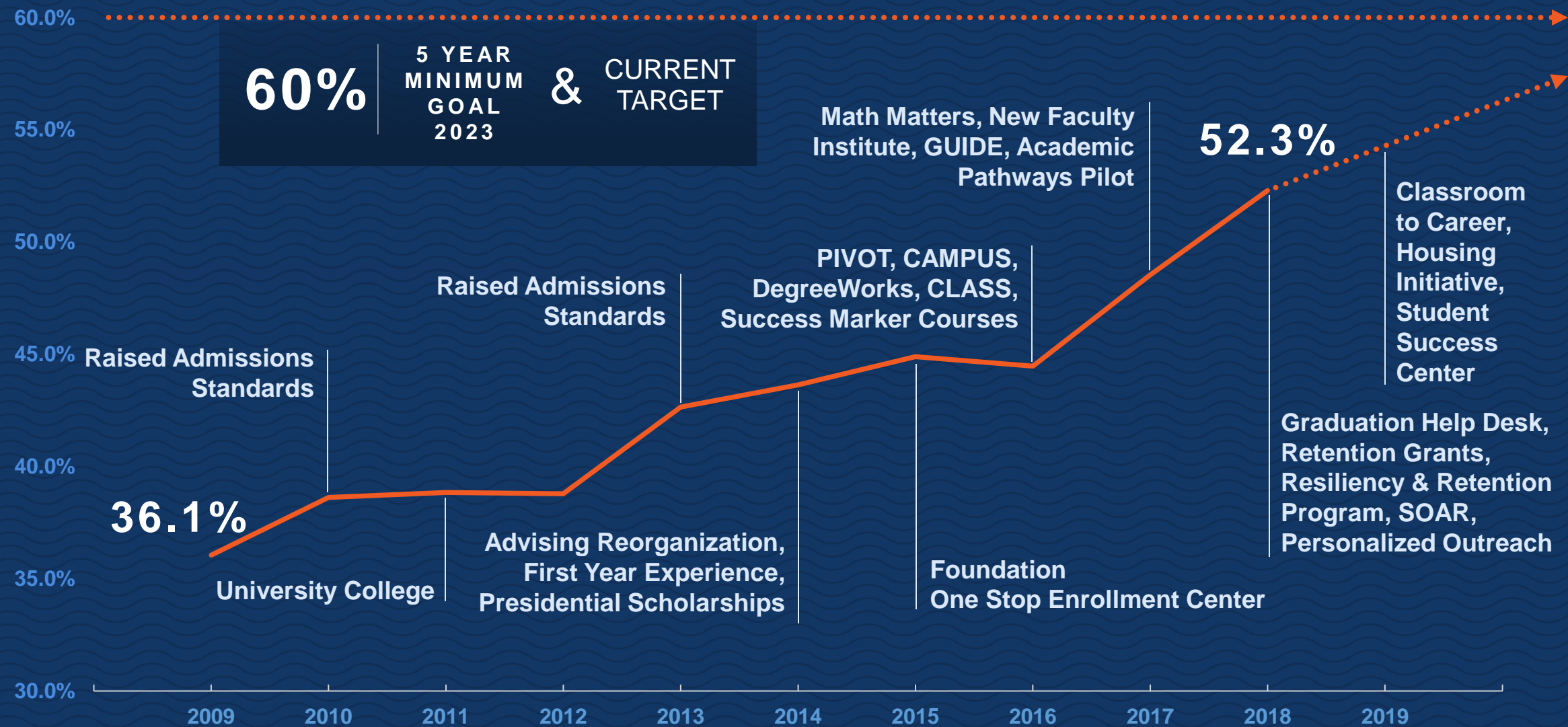

Data as reported to the Integrated Postsecondary Education Data System (IPEDS)

A MODEL FOR STUDENT SUCCESS

# Four-Year Graduation Rates

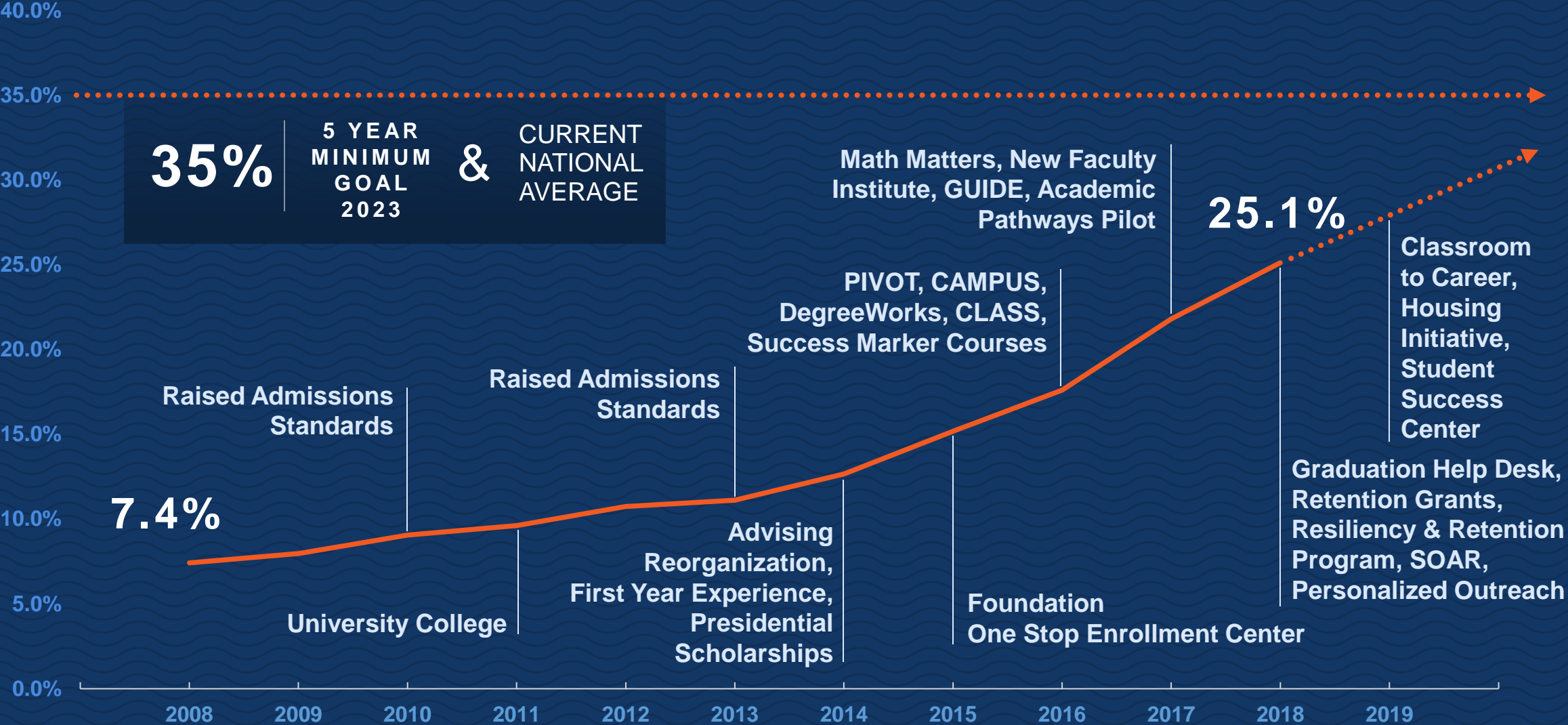

Data as reported to the Integrated Postsecondary Education Data System (IPEDS)

## A MODEL FOR STUDENT SUCCESS

# Six-Year Graduation Rates

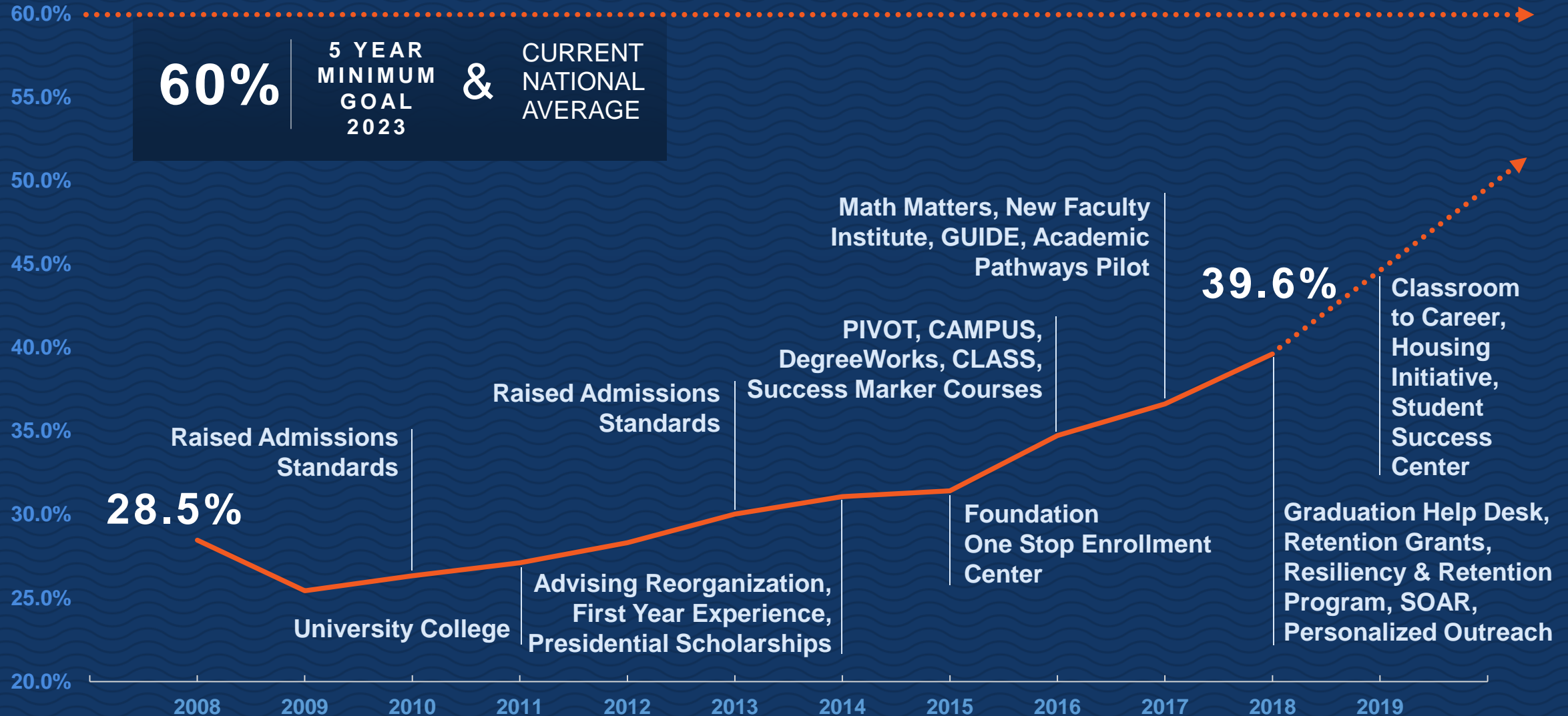

Data as reported to the Integrated Postsecondary Education Data System (IPEDS)

A decorative vertical border on the left side of the slide, featuring a dark blue background with a white scalloped edge. It contains several horizontal wavy lines in light blue and orange, resembling water or stylized waves.

# A great public research university

With a focus on driving San Antonio's knowledge economy, UTSA is an urban-serving university of the future living out the notion that great universities need great cities, and great cities need great universities. As a discovery enterprise on the fast track to attaining National Research University Fund eligibility and an R1 designation by the Carnegie Commission, UTSA is positioned to align with members of the prestigious Association of American Universities.

A GREAT PUBLIC RESEARCH UNIVERSITY

# UTSA's Trajectory





## A GREAT PUBLIC RESEARCH UNIVERSITY

Tenure and tenure-track UTSA faculty with degrees from AAU and R1 Institutions

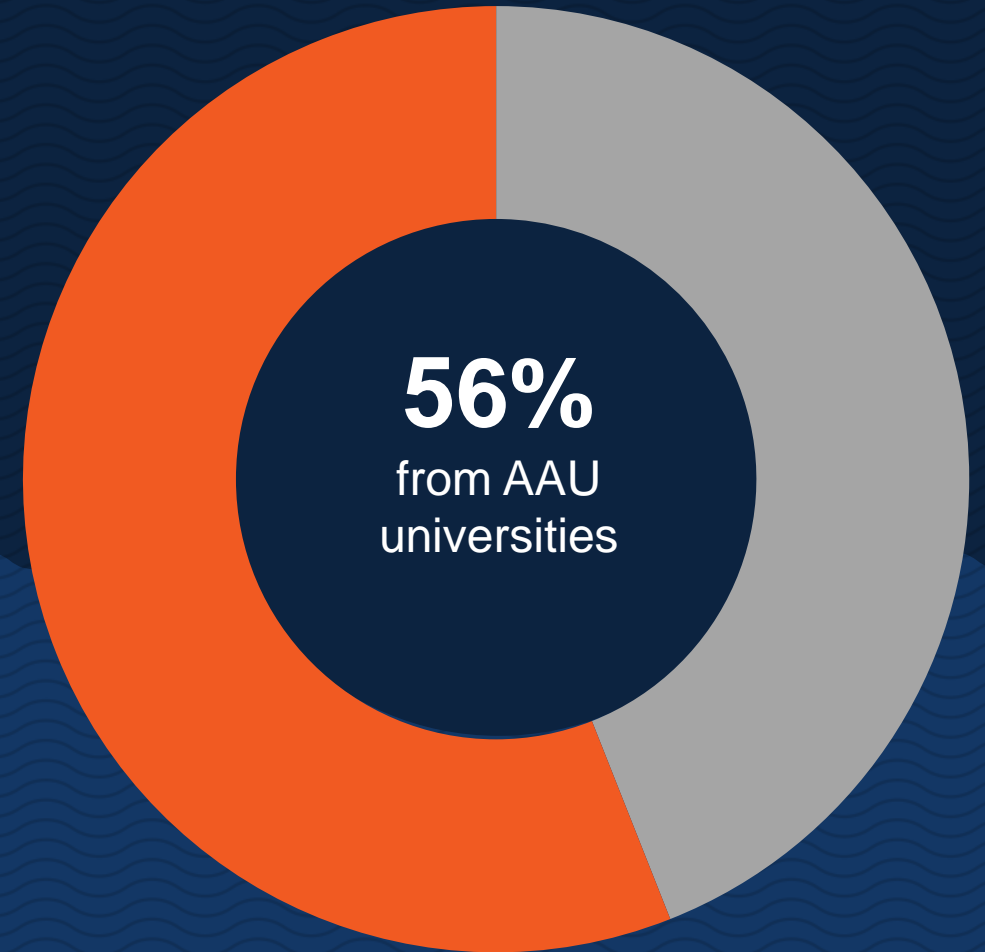
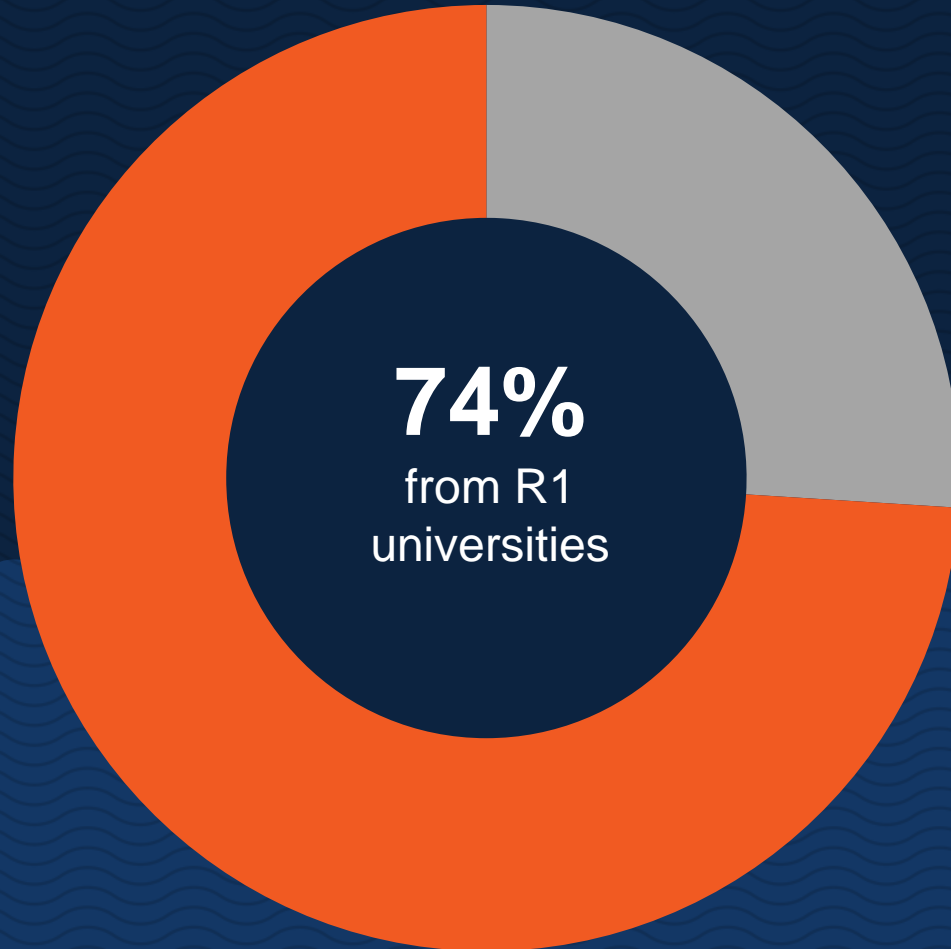

A GREAT PUBLIC RESEARCH UNIVERSITY

## New Graduate Students Rising Enrollment

**36.2%**  
Increase

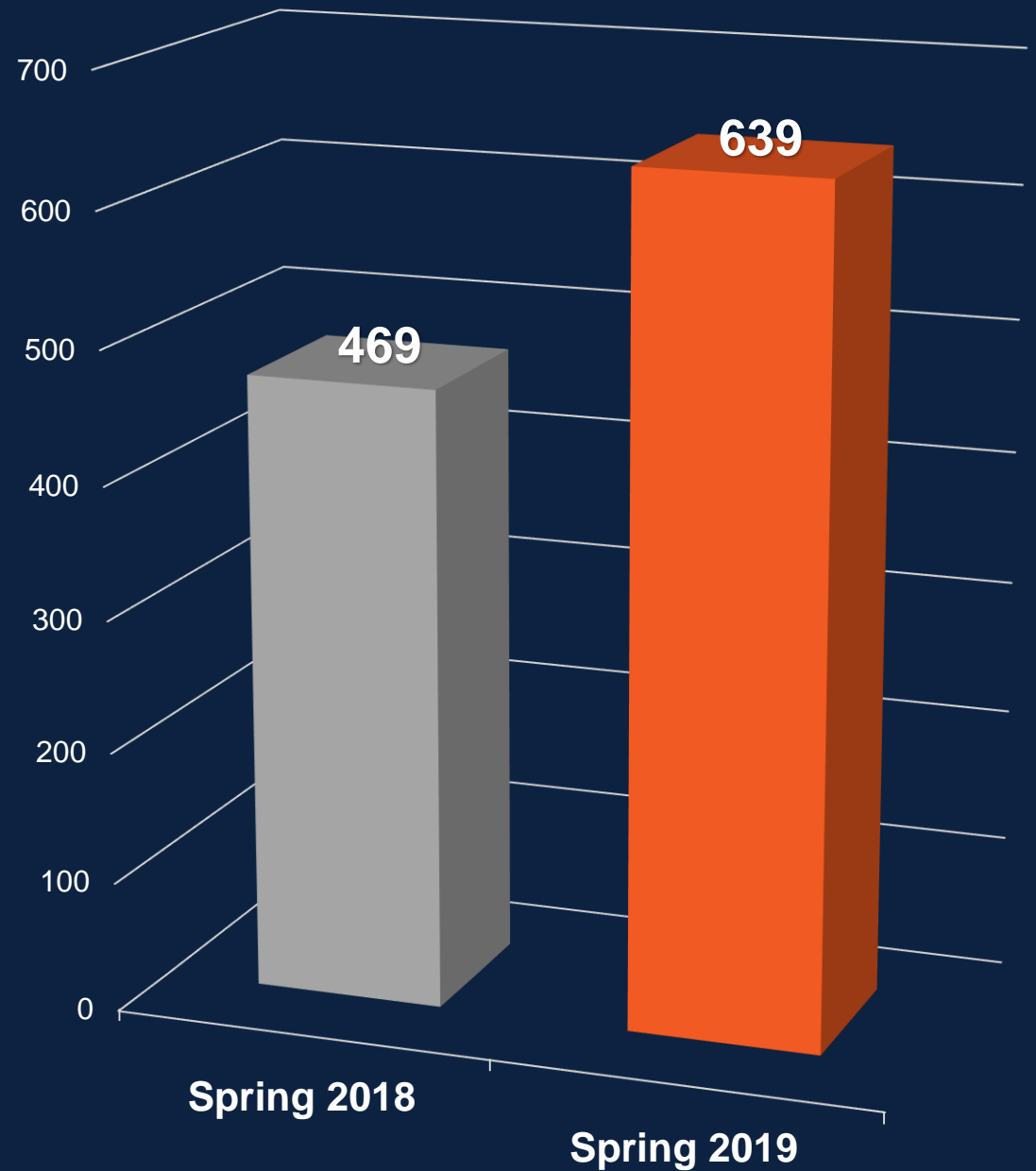

A GREAT PUBLIC RESEARCH UNIVERSITY

# UTSA's Research Momentum

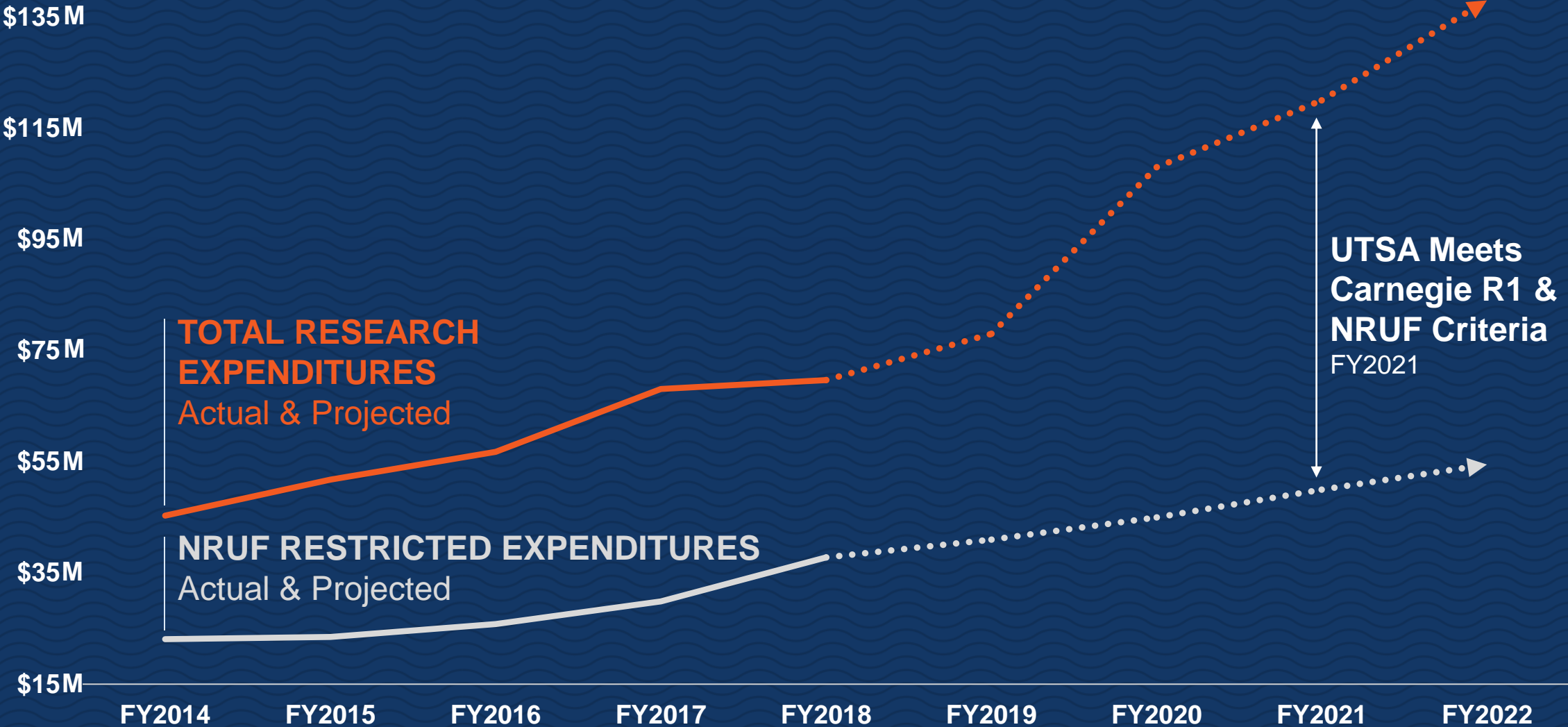

# Advancing Research Excellence

# Distinguished Faculty Awards

## National Academy of Inventors

### Bernard Arulanandam

Interim VPREDKE and Jane & Roland  
Professor of Biosciences  
Biology, COS  
*Year of Receipt - 2018*

## American Association for the Advancement of Science

### Floyd Wormley

Microsoft President's Professorship and Sr.  
Assoc. Dean for Research & Graduate  
Studies, Biology, COS  
*Year of Receipt - 2018*

## NSF Faculty Early Career Development Program

### Victor Maldonado

Mechanical Engineering, COE  
*Year of Receipt - 2018*

## American Association for the Advancement of Science

### Banglin Chen

Dean's Distinguished Professor  
Chemistry, COS  
*Year of Receipt - 2017*

## American Society of Civil Engineers

### Samer Dessouky

Professor  
Civil & Environmental Engineering  
*Year of Receipt - 2017*

## American Council of Learned Societies

### Laura Eichelberger

Anthropology, COLFA  
*Year of Receipt - 2017*

## American Academy of Microbiology

### Bernard Arulanandam

Interim VPREDKE and Jane & Roland  
Professor of Biosciences  
Biology, COS  
*Year of Receipt - 2017*

## Chapter Service Recognition Award, American Statistical Association

### David Han

Associate Professor  
Management Sciences & Statistics, COS  
*Year of Receipt - 2017*

## Woman Physicist of the Month, American Physics Society

### Kiran Bhaganagar

Associate Professor  
Chemistry, COS  
*Year of Receipt - 2017*

## NSF Faculty Early Career Development Program

### Abdullah A. Muzahid

Computer Science, COS  
*Year of Receipt - 2017*

## Institute for Electrical & Electronics Engineers

### Sos Agaian

Electrical & Computer Engineering, COE  
*Year of Receipt - 2017*

## IBM Faculty Awards

### Weining Zhang

Associate Professor  
Computer Science, COS  
*Year of Receipt - 2017*

## Joseph B. Glitter Award

### Rogelio Saenz

Mark G. Yudof Endowed Professor  
Demography, COPP  
*Year of Receipt - 2017*

## Society for Social Work & Research

### Amy Chanmugan

Associate Professor & Dept. Chair  
Social Work, COPP  
*Year of Receipt - 2017*

## Core US Scholar Program

### Martha Sidbury Christiansen

Associate Professor & Dept. Chair  
Bicultural & Bilingual Studies, COEHD  
*Year of Receipt - 2017*

Advancing Research  
Excellence

# Distinguished Student Awards

2017-2019



# Pathway to Carnegie R1

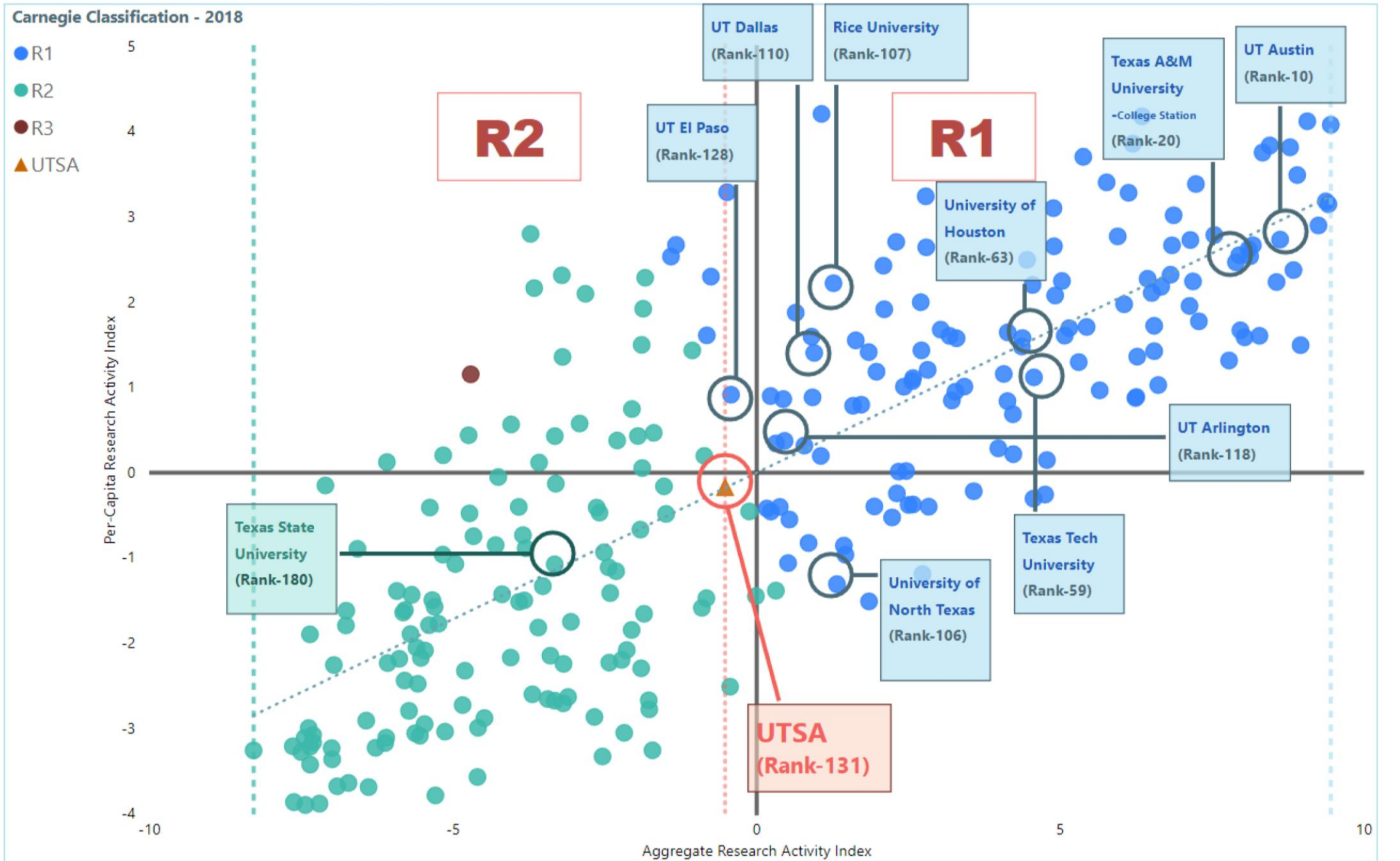



# An exemplar for **strategic growth and innovative excellence**

UTSA will realize its full potential as a university by growing to become a more comprehensive institution. By focusing on nimbleness and continuous improvement, UTSA integrates innovative approaches and best practices to ensure goals align with operational processes. With a reputation as a great place to work, UTSA actively cultivates the excellence of its people.

STRATEGIC GROWTH & INNOVATIVE EXCELLENCE

# UTSA's Enrollment Growth

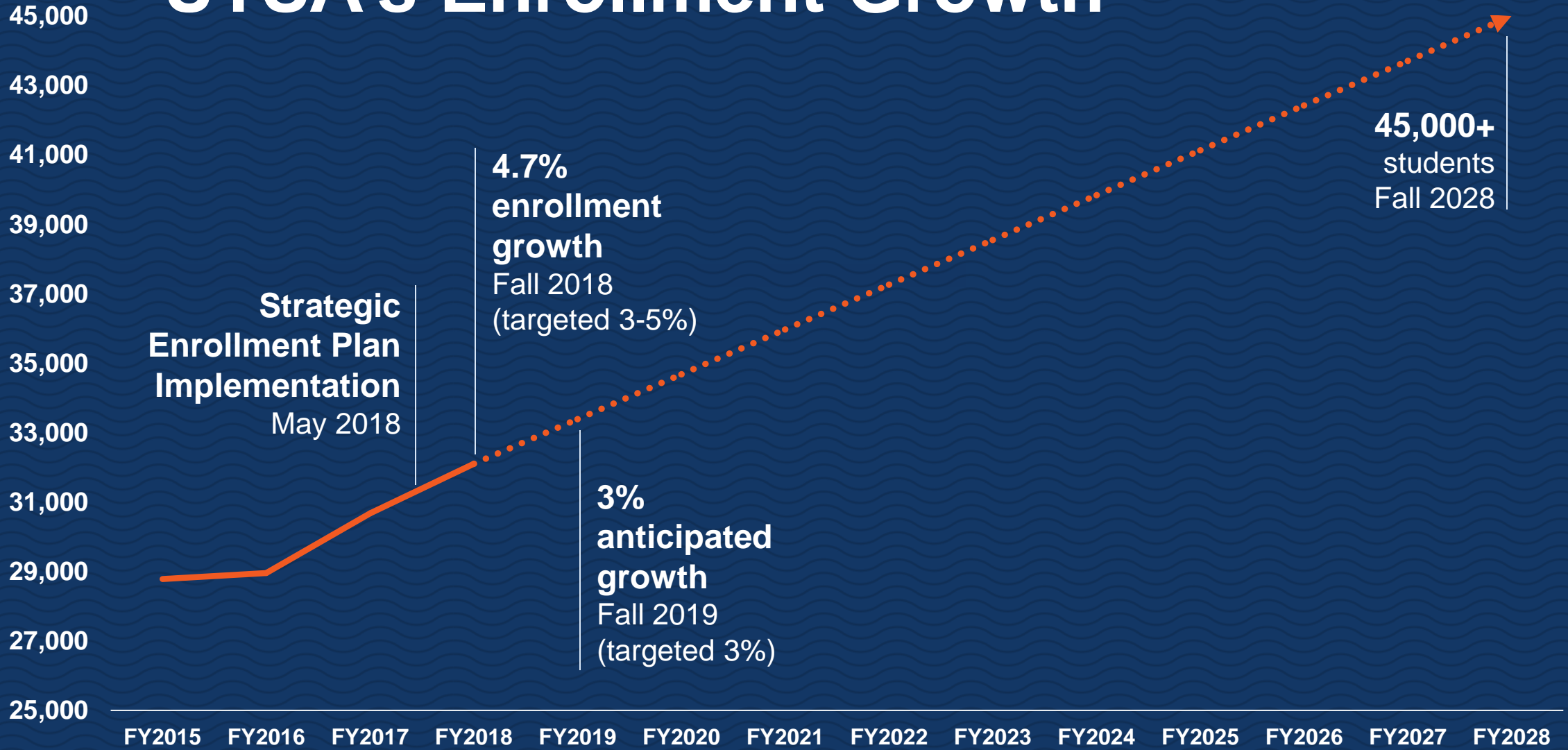



STRATEGIC GROWTH & INNOVATIVE EXCELLENCE



# UTSA<sup>®</sup> Transfer Credit Calculator

Simplifies transfer admissions, making it  
easy to determine which credits will  
transfer to UTSA



STRATEGIC GROWTH & INNOVATIVE EXCELLENCE

On the Horizon  
**Workplace  
Satisfaction Survey**

---

Recognizing the importance of staff by  
ensuring UTSA is a great place to work



The logo for UTSA (University of Texas at San Antonio) is located in the upper left corner. It consists of the letters "UTSA" in a white, bold, sans-serif font. Above the text are three wavy lines: the top one is orange, and the two below it are blue. The entire logo is set against a dark blue background with a white scalloped edge on the left side.

UTSA®

---

# Reimagining the Downtown Campus



San Antonio River

Pearl

San Antonio Riverwalk

Hemisfair Park

St. Paul's Square

Alamodome

San Pedro Creek Cultural Park

Alameda Theater

Frost Tower

**UTSA**  
Downtown Campus

*Zona Cultural*

H-E-B  
Headquarters

**UTSA**  
Institute of Texan Cultures

Site of New  
Federal Courthouse

San Antonio  
Missions

Southtown

500 ft

San Antonio River  
San Pedro Creek

Riverwalk

San Antonio River

**Frio Street Properties**  
14.3 acres

**Cattleman's Square Residential Tower**

**Continental Hotel Residences**

**Proposed Downtown Campus | 8.08 acres**

**Current Downtown Campus | 18.3 acres**

**Expanded College of Business**

**New National Security Collaboration Center**

**New School of Data Science**

**San Pedro Creek**

# Ten Year Plan 2018-2028

**PHASE 1: 2018-2023**

**PHASE 2: 2023-2028**





UTSA®

---

# Strategic Initiatives

*[utsa.edu/strategicplan](https://utsa.edu/strategicplan)*

# Preventing Sexual Assault & Misconduct

---

A university-wide framework to ensure a safe place for all Roadrunners to study, work and live



# Capital Campaign

---

Providing UTSA with the infrastructure and resources to achieve recognition as a model for student success and research discovery





# Strategic Communications

---

A comprehensive, integrated marketing program that builds brand awareness and positive perceptions of UTSA



# Roadrunner Village

---

A vibrant new neighborhood featuring housing, dining and retail space that enhances the campus experience for the university community.



# Guadalupe Hall

---

Designed with student success in mind, UTSA's newest residence hall will house 372 freshmen



# Honors Residential College

---

A new residence hall for the university's top students, bringing UTSA's Honors College to new levels of national prominence



# Roadrunner Athletics Center of Excellence

A comprehensive multipurpose sports center to address student-athlete academic success, safety, performance and wellness

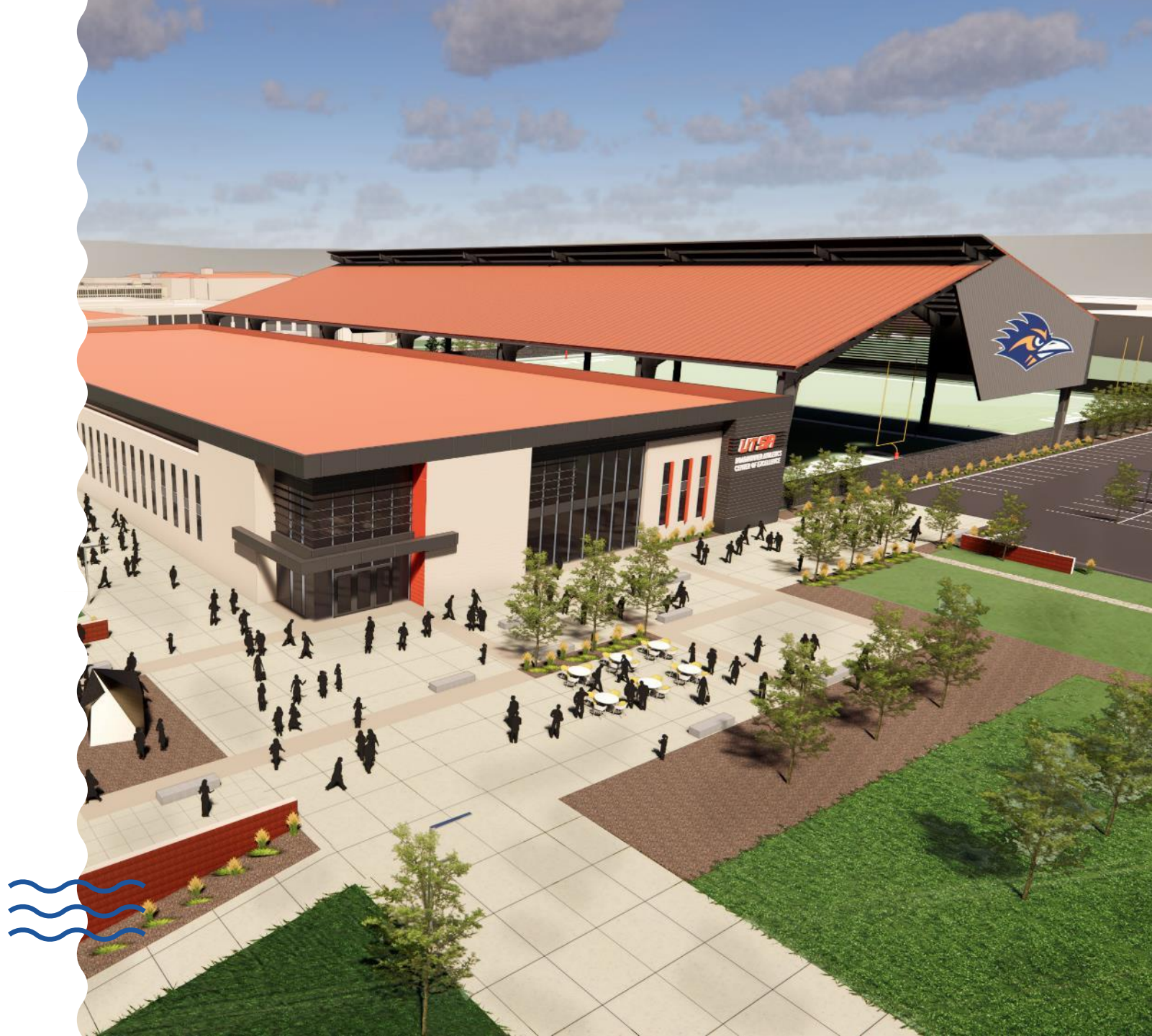

# Cattleman's Square Residential Tower

---

A mixed-use residential facility to house UTSA's growing population at the Downtown Campus



Arizona State University  
Taylor Place Residence Hall

# Continental Hotel Residences

---

A mixed-use residential facility to house UTSA's growing population at the Downtown Campus

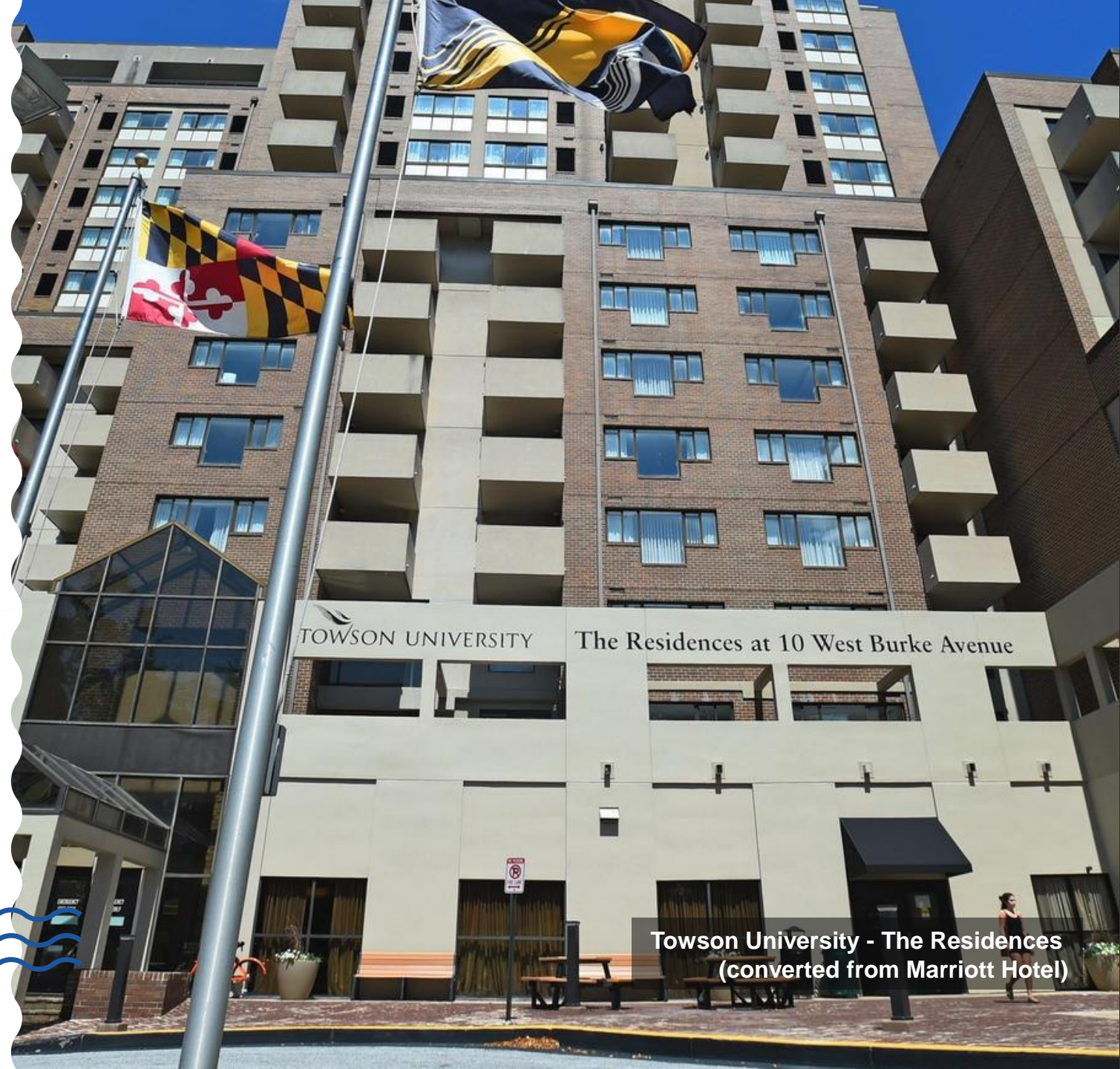

Towson University - The Residences  
(converted from Marriott Hotel)

**UTSA<sup>®</sup>**



*1969-2019*



# Campus Master Plan

---

Guiding the development  
of UTSA's campuses  
over the next decade



## ACREAGE

# UTSA Campuses

- 758 total acres
- 573 developable acres



**Main Campus**  
*600 acres | 495.2 developable acres*



**Downtown Campus**  
*18.3 acres | 8.3 developable acres*



**Park West Campus**  
*125 acres | 70 developable acres*

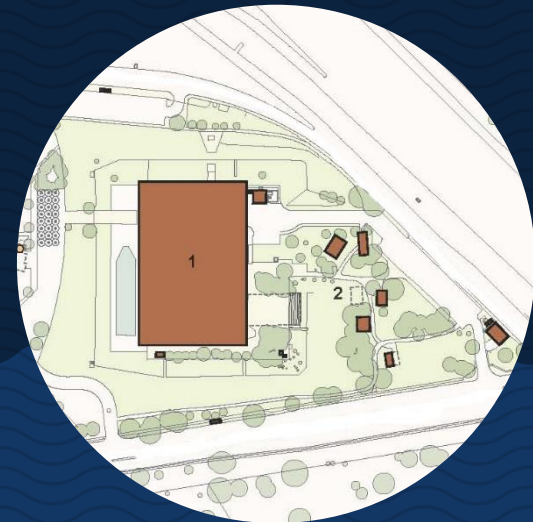

**Institute of Texan Cultures**  
*14.6 acres | 0 developable acres*

# School of Data Science

---

Uniting UTSA's talent and resources in cyberscience, data science and data management into one powerful new school



Columbia University  
Data Sciences Institute

# National Security Collaboration Center

---

Solving the nation's  
greatest cybersecurity  
threats



# Expanding the College of Business

---

A second location to accommodate rapid enrollment growth, situated in the heart of San Antonio's business community



Portland State University  
School of Business

# Strategic Faculty Hiring for 2020

---

- Clustered and Connected Hiring
- Advancing Academic Excellence through Accelerating Faculty Diversity Hiring
- Dual Career Academic Partners Hiring
- Advancing Academic Excellence through Accelerated Hiring of Nationally Recognized Faculty
- Voluntary Separation Incentive



# Clustered and Connected Hiring

Attract scholars who will add depth and expertise in specific areas and connect the efforts of our existing faculty to enhance our competitiveness to address national societal needs





# Advancing Academic Excellence through Accelerating Faculty Diversity Hiring

---

Provide university designated funding to academic colleges, schools and departments to support additional hiring of diverse full-time, tenured/tenure-track faculty who will advance inclusive excellence at UTSA





# Dual Career Academic Partners Hiring

---

Provide enabling university financial support to academic colleges, schools and departments to address the needs of dual career academic couples



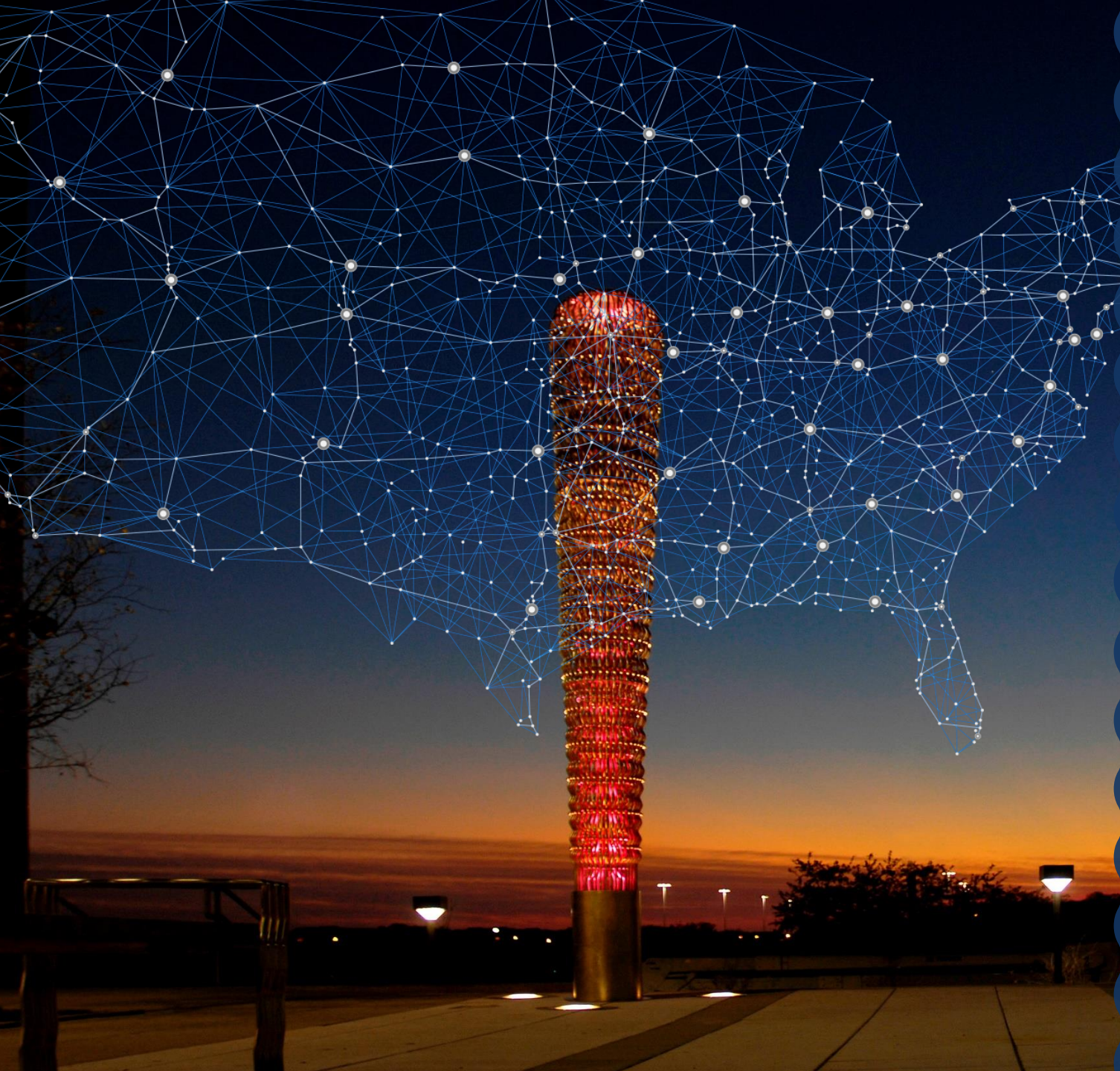

# Advancing Academic Excellence through Accelerated Hiring of Nationally Recognized Faculty

---

Provide university designated funding to academic colleges, schools and departments to support the hiring of additional nationally/internationally-recognized, highly accomplished full-time, tenured faculty



# Voluntary Separation Incentive

Support eligible tenured faculty who make be interested in making a life or career change



# Human Health Planning Advisory Task Force

---

Exploring a new, student-centric college organizational structure that prepares students to pursue careers in modern healthcare settings



# Classroom to Career

---

Providing transformative learning experiences such as internships, service learning, undergraduate research, study abroad and more





Questions?  
Thank you!

Feedback  
[bit.ly/campusconvo](https://bit.ly/campusconvo)

